

SERIES AZ 9200

SINGLE STAGE REGULATOR

Flow Rates to 2,000 SLPM (71 scfm)



- SS 316L construction
- High performance
- 10 µin. surface finish
- High flow with low particle generation
- 3/4 and 1 inch port size
- Tied diaphragm design
- Vacuum to 300 psig (21 bar) inlet
- Knob LOTO (refer to AP KL data sheet)
- Installation and operating instructions available at www.aptech-online.com in the Tech Briefs section

Operating Parameters

| | | |
|-------------------|---------|--------------------------------|
| Source pressure | AZ 9200 | vacuum to 300 psig (21 bar) |
| Delivery pressure | AZ 9202 | 1 to 30 psig (0.07 to 2 bar) |
| | AZ 9206 | 2 to 60 psig (0.14 to 4 bar) |
| | AZ 9210 | 2 to 100 psig (0.14 to 7 bar) |
| | AZ 9215 | 5 to 150 psig (0.34 to 10 bar) |
| Proof pressure | | 150% of operating pressures |
| Burst pressure | | 300% of operating pressures |

Other Parameters

| | |
|-------------------------|--|
| Inlet/outlet connectors | 3/4 or 1 inch face seal or tube weld |
| Flow coefficient (Cv)** | 1.6 |
| Internal volume | 2.2 in ³ (36 cm ³) |
| Operating temperature | -40° to +160°F (-40° to +71°C) |
| Surface finish | 10 µin. (0.25 µm) Ra avg. |
| Inboard leakage | 2 x 10 ⁻¹⁰ sccs |
| Outboard leakage | 1 x 10 ⁻⁹ sccs He |
| Leakage across seat | 4 x 10 ⁻⁸ sccs He |
| Installation | surface or panel (optional) |
| Supply pressure effect | 7 psig per 100 psig source pressure change |

**A pressure regulator Cv is a nominal value which indicates the point of choked flow. Please refer to a flow curve or a recommendation guide for usable flow range.

Materials

| Series AZ 9200 S | |
|------------------|--------------------------------|
| Wetted Parts | |
| Body, nozzle | stainless steel 316L* |
| Poppet | stainless steel 316L |
| Diaphragm | Ni-Cr-Mo alloy / UNS N06022 |
| Finish | electropolished and passivated |
| Seat | PFA |

*Please refer to product note PN 414 regarding single melt 316L SS material. All specifications subject to change without notice.

SERVICE AND SUPPORT BEYOND COMPARE

DIMENSIONAL INFORMATION

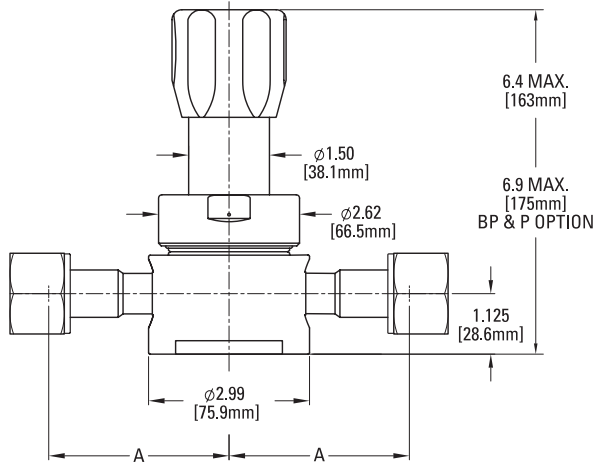

| Connection | A | |
|------------|-----------|------|
| | in | mm |
| FV12, MV12 | 3.39 ±.03 | 86.1 |

All dimensions in inches (mm).
Metric dimensions are for reference only.

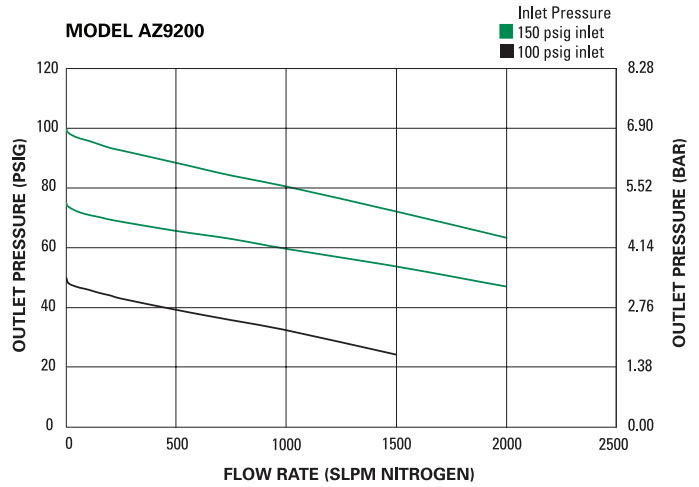

PORTING CONFIGURATIONS

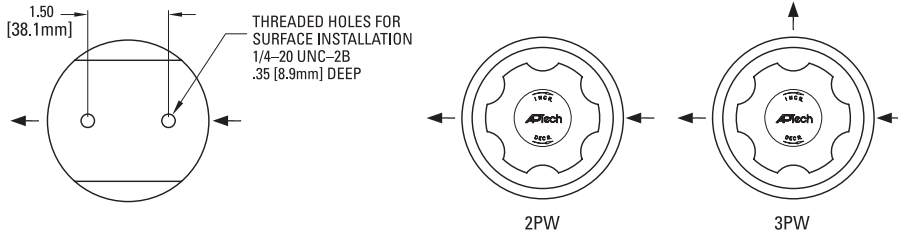

CAUTION: Product selection is the sole responsibility of the user, regardless of any recommendations or suggestions made by the factory. The user shall make selections based upon their own analysis and testing with regard to function, material compatibility and product ratings. Proper installation, operation and maintenance are also required to assure safe, trouble free performance.

ORDERING INFORMATION

Sample Order Number

AZ 9210S 3PW FV12 FV12 1 P

AZ 9210 | Series

AZ 9202 = 1-30 psig (.07 to 2 bar)
AZ 9206 = 2-60 psig (.14 to 4 bar)
AZ 9210 = 2-100 psig (.14 to 7 bar)
AZ 9215 = 5-150 psig (.34 to 10 bar)

S | Material

S = Stainless steel (SS)

3PW | Ports

2PW = 2 ports butt weld
3PW = 3 ports butt weld

FV12 FV12 | Connections
Inlet / Outlet

FV12 = 3/4 inch face seal female
MV12 = 3/4 inch face seal male
TW12 = 3/4 inch tube stub weld
FV16 = 1 inch face seal female
MV16 = 1 inch face seal male
TW16 = 1 inch tube stub weld

1 | Delivery
Gauge*

0 = No gauge
V3 = 30-0-30 psig/bar
L = 30-0-60 psig/bar
1 = 30-0-100 psig/bar
H = 30-0-160 psig/bar

* Standard gauge port is 1/4 inch face seal male (1/4 inch female available).

P | Options

P = Panel installation**
BP = Bonnet vent port
KL = Knob LOTO
(refer to AP KL data sheet)

** Panel hole 1.56" diameter.

AP Tech has product options and variations which are not documented in data sheets. If you have a model number that is not defined by the ordering information, please consult the factory or your local representative.